

REVISIONS		
REV. NO.	DESCRIPTION	DATE

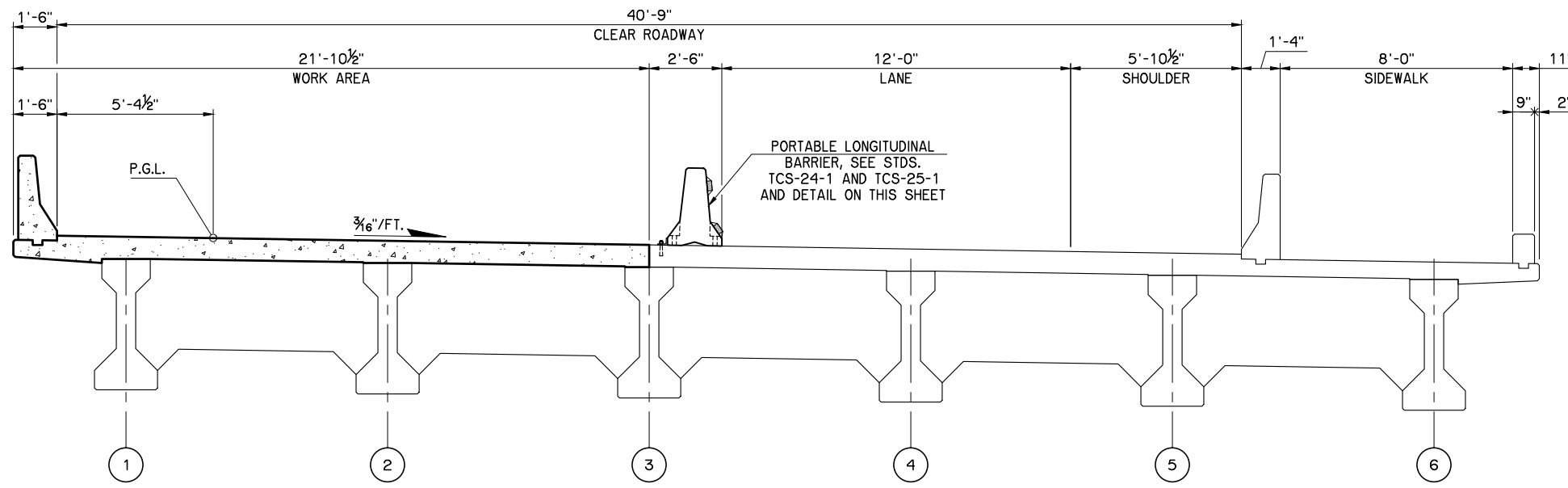

**PHASE I DECK REPAIR**

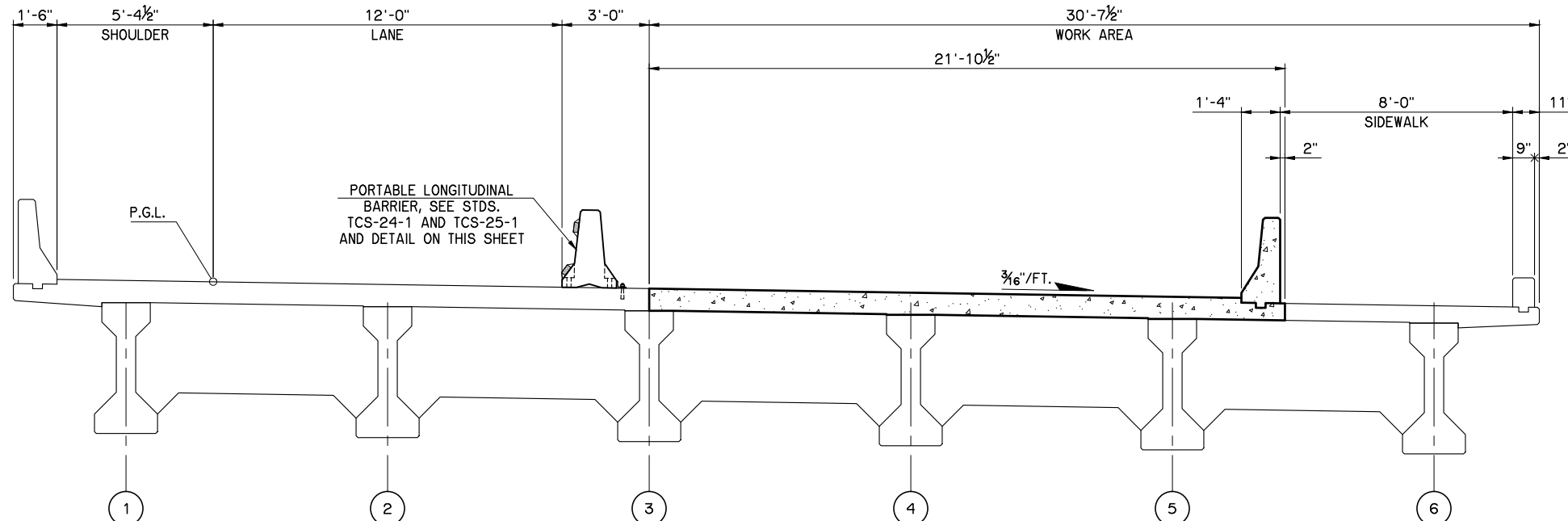

**PHASE II DECK REPAIR**

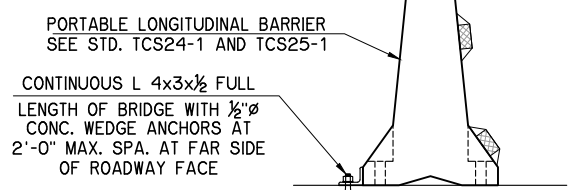

**PORTABLE LONGITUDINAL BARRIER DETAIL**

**NOTE**  
 PROVIDE CONCRETE WEDGE ANCHORS HAVING A MINIMUM ULTIMATE PULLOUT CAPACITY OF 10,000 POUNDS AND A MINIMUM ULTIMATE SHEAR CAPACITY OF 13,000 POUNDS. SUBMIT THE TYPE OF CONCRETE WEDGE ANCHOR TO THE ENGINEER FOR APPROVAL PRIOR TO INSTALLATION.

INSTALL ANGLE AND ANCHORS ON WORK AREA SIDE OF BARRIER. AFTER REMOVING ANCHORS, FILL HOLES IN THE DECK IN A MANNER APPROVED BY THE ENGINEER. INCLUDE ALL COSTS FOR THE ANGLES, CONCRETE WEDGE ANCHORS, HOLE REPAIR, LABOR, AND INCIDENTALS NECESSARY IN THE CONTRACT UNIT PRICE FOR "DELIVER PORTABLE LONGITUDINAL BARRIER" AND "RELOCATION OF PORTABLE LONGITUDINAL BARRIER". REFER TO TRAFFIC CONTROL PLANS FOR LOCATIONS.

**CONSTRUCTION SEQUENCE**

**A. DECK REPAIRS**

**PHASE I**

1. INSTALL PORTABLE LONGITUDINAL BARRIERS AND TEMPORARY TRAFFIC CONTROL AS INDICATED ON THIS SHEET AND TRAFFIC CONTROL PLANS TO RESTRICT TRAFFIC TO ONE LANE ON THE EAST SIDE OF THE EXISTING BRIDGE. WHEN TEMPORARY TRAFFIC CONTROL IS IN PLACE, DIVERT TRAFFIC.
2. REMOVE EXPANSION JOINT EXTRUSIONS AND ASSOCIATED 2'-0" PORTIONS OF EXISTING BRIDGE DECK AND WEST SIDE PARAPET AT EACH PIER, AS INDICATED ON THE PLANS AS CLASS C DECK REPAIR.
3. INSTALL NEW EXPANSION JOINT EXTRUSIONS. CONSTRUCT ASSOCIATED PORTIONS OF BRIDGE DECK AND WEST SIDE PARAPET.
4. CONSTRUCT CLASS B BRIDGE DECK REPAIR AT ABUTMENTS AND PNEUMATIC MORTAR REPAIR ON WEST SIDE PARAPET AS SHOWN ON THE PLANS.
5. INSTALL NEOPRENE GLAND FOR EXPANSION JOINTS INTO EXTRUSIONS. PROVIDE A CONTINUOUS NEOPRENE GLAND THRU WIDTH OF BRIDGE, DO NOT CUT NEOPRENE GLAND BETWEEN PHASES. ROLL UP UNUSED PORTION OF GLAND FOR INSTALLATION IN PHASE II.
6. CONSTRUCT PORTIONS OF NEW APPROACH SLABS.
7. APPLY FLOODCOAT TO THE DECK AND PARAPET AS INDICATED ON THE PLANS.

**PHASE II**

1. RELOCATE PORTABLE LONGITUDINAL BARRIERS AND TEMPORARY TRAFFIC CONTROL AS INDICATED ON THIS SHEET AND TRAFFIC CONTROL PLANS.
2. GROUT ANCHOR HOLES USED TO ANCHOR PORTABLE LONGITUDINAL BARRIER.
3. DIVERT TRAFFIC TO WEST SIDE OF BRIDGE.
4. REMOVE REMAINING PORTIONS OF EXPANSION JOINT EXTRUSIONS AND ASSOCIATED PORTIONS OF EXISTING BRIDGE DECK ALONG WITH EAST SIDE PARAPET AT EACH PIER. REMOVE NEOPRENE GLAND AND CLEAN EXISTING ARMORED JOINTS AT SIDEWALK.
5. INSTALL NEW EXPANSION JOINT EXTRUSIONS AND CONSTRUCT ASSOCIATED PORTIONS OF BRIDGE DECK AND EAST SIDE PARAPET.
6. CONSTRUCT CLASS B BRIDGE DECK REPAIR AT ABUTMENTS AND PNEUMATIC MORTAR REPAIR ON EAST SIDE PARAPET AS SHOWN ON THE PLANS.
7. INSTALL REMAINDER OF NEOPRENE GLAND FOR EXPANSION JOINTS INTO EXTRUSIONS. RESEAL JOINTS AT SIDEWALK WITH SILICONE SEALANT.
8. CONSTRUCT REMAINDER OF NEW APPROACH SLABS.
9. APPLY FLOODCOAT TO REMAINING PORTIONS OF THE DECK AND PARAPET AS INDICATED ON THE PLANS.
10. REMOVE PORTABLE LONGITUDINAL BARRIERS AND GROUT THE ANCHOR HOLES.

**PHASE III**

1. MILL AND OVERLAY ROADWAY TRANSITIONS AND INSTALL POSTS, GUARDRAIL AND CONNECTIONS AS SHOWN ON THE PLANS, USING SHORT DURATION TRAFFIC CONTROL METHODS AS DETERMINED BY THE CONTRACTOR AND APPROVED BY THE FIELD ENGINEER.

**B. BEAM REPAIR AND BEARING REPLACEMENT**

1. REPAIR BEAM ENDS AND DIAPHRAGM ENDS ON LOCATIONS SHOWN ON THE PLANS.
2. REPAIR THE TOP OF PIER CAPS ON ALL LOCATIONS SHOWN.
3. REPLACE BEARINGS AT ALL PIERS AND ABUTMENTS.

**C. SUBSTRUCTURE REPAIRS**

1. REPAIR PIERS BELOW PIER CAPS AT ALL LOCATIONS SHOWN ON THE PLANS.
2. REPAIR ABUTMENTS.

SH 51 NB OVER ARKANSAS RIVER		TULSA COUNTY	
Design	ADT	Detail	FEZ
Check	ADT	Check	ADT
<b>CONSTRUCTION SEQUENCE</b>			
WHITE ENGINEERING ASSOCIATES			
<b>STATE OF OKLAHOMA</b>		DEPARTMENT OF TRANSPORTATION	
JOB PIECE NO. 31358(04)		SHEET NO. 10	

I:\Active\1626\Drawings\10 Construction Sequence.dwg, 6/12/2017 11:09:13 AM, Fred